

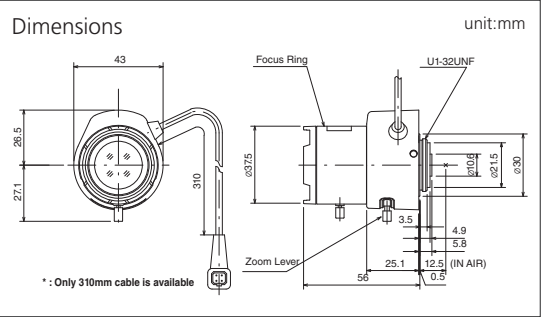

- VARI
- DC
- ASP
- IR
- MEGA PIXEL
- SECURITY



MODEL NO.	TG4Z2813FCS-MPIR
Format (")	1/3
Mount	CS
Focal Length (mm)	2.8-12
Aperture (F)	1.3-360
Angle of View (HOR)°	102.2-23.7
M.O.D. (m)	0.3
Effective Aperture	Front (φmm) 23.0
	Rear (φmm) 7.4
Front Filter Thread (φMxP=)	-
Dimensions	<sup>(φxL)</sup> (φxHxD) or (WxHxD)mm
	φ37.5 × 48 × 56
Weight (g)	71



- VARI
- MANUAL
- MEGA PIXEL
- SECURITY



MODEL NO.	H2Z0414C-MP
Format (")	1/2
Mount	C
Focal Length (mm)	4-8
Aperture (F)	1.4-16C
Angle of View (HOR)°	90.4-47.0
M.O.D. (m)	0.5
Effective Aperture	Front (φmm) 22.2
	Rear (φmm) 10.7
Front Filter Thread (φMxP=)	-
Dimensions	<sup>(φxL)</sup> (φxHxD) or (WxHxD)mm
	φ41.6 × 48.8
Weight (g)	72

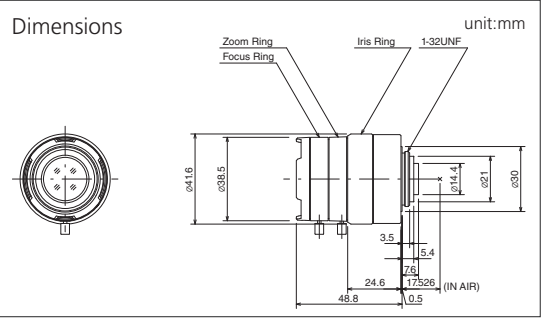

- VARI
- DC
- MEGA PIXEL
- SECURITY



MODEL NO.	HG2Z0414FC-MP
Format (")	1/2
Mount	C
Focal Length (mm)	4-8
Aperture (F)	1.4-360
Angle of View (HOR)°	90.4-47.0
M.O.D. (m)	0.5
Effective Aperture	Front (φmm) 22.2
	Rear (φmm) 10.7
Front Filter Thread (φMxP=)	-
Dimensions	<sup>(φxL)</sup> (φxHxD) or (WxHxD)mm
	φ38.5 × 48 × 48.8
Weight (g)	75

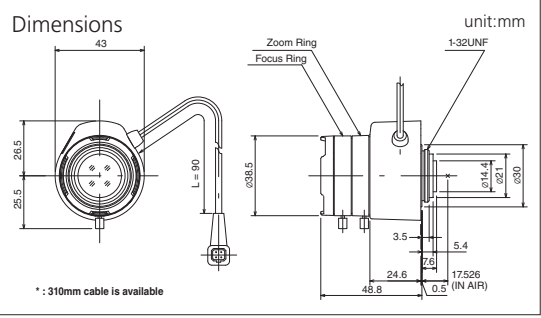

- VARI
- MANUAL
- MEGA PIXEL
- SECURITY



MODEL NO.	M3Z1228C-MP
Format (")	2/3
Mount	C
Focal Length (mm)	12-36
Aperture (F)	2.8-16C
Angle of View (HOR)°	41.0-13.6
M.O.D. (m)	0.2
Effective Aperture	Front (φmm) 27.2
	Rear (φmm) 12.1
Front Filter Thread (φMxP=)	35.5 × 0.5
Dimensions	<sup>(φxL)</sup> (φxHxD) or (WxHxD)mm
	φ41.6 × 53
Weight (g)	105

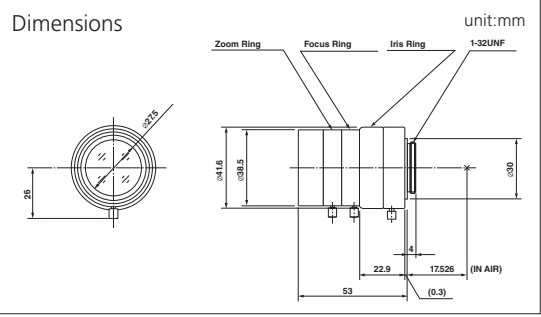

\*Please note M3Z1228C-MP is produced to order

- FEATURE INDICATION
- MODEL NAME
- CODING RULE
- MANUAL IRIS
- AUTO IRIS
- VARI-FOCAL
- MANUAL IRIS
- VARI-FOCAL
- AUTO IRIS
- MANUAL ZOOM
- MOTORIZED ZOOM
- PINHOLE
- ACCESSORIES
- MEGAPIXEL & FA
- TECHNICAL INFORMATION
- ANGLE OF VIEW